

cecotec

RETROTWIST BLACK/YELLOW/GREEN/RED/BLUE

Batidora de vaso retro/retro jug blender



Manual de instrucciones
Instruction manual
Manuel d'instructions
Bedienungsanleitung
Manuale di istruzioni
Manual de instruções
Handleiding
Instrukcja obsługi
Návod k použití

1. PARTS AND COMPONENTS

Fig. 1

1. Cap
2. Lid
3. Jug
4. Blades
5. Main body

NOTE:

The graphics in this manual are schematic representations and may not exactly match the device.

2. BEFORE USE

- This appliance is packaged in a way as to protect it during transport. Take the appliance out of its box and remove all packaging materials. You can keep the original box and other packaging elements in a safe place. This will help you prevent damage to the appliance when transporting it in the future. In case the original packaging is disposed of, make sure all packaging materials are recycled accordingly.
- Make sure all parts and components are included and in good conditions. If there is any piece missing or in bad conditions, contact the official Cecotec Technical Support Service immediately.

Box content

- RetroTwist jug blender
- Instruction manual

3. OPERATION

1. Place the appliance on a stable surface.
2. Screw the blades into the bottom of the jug.
3. To blend, first add water into the jug and then add the ingredients to be blended, cut into small pieces. Make sure not to exceed the maximum jug capacity.
4. Put the lid on the jug and then place the jug on the blender body. To fix it, turn it clockwise.
5. Connect the blender to the mains.

NOTE: the blender has two indicator lights. The lower one indicates that the blender is connected to the mains and in operation. The top one indicates that the blades are active.

6. Press the lever to start the blender.
7. When you have finished using the blender, switch it off and disconnect it from the mains.
8. Remove the jug from the blender body by turning it counterclockwise.
9. Finally, open the lid and remove the mixture.

NOTE: do not mix only food that does not contain water.

NOTE: do not blend or use the jug with ingredients above 70 °C.

4. CLEANING AND MAINTENANCE

Cleaning

- To clean the blades properly, first rinse the jug with water. Fill the jug with 400 ml of lukewarm water and add some detergent soap. Close the jug with the lid and operate the appliance in 2-second periods. Repeat the process as many times as necessary.
- Always unplug the appliance after each use and before cleaning.
- Use water to clean the jug. Do not use chemical or harsh abrasive cleaning agents.
- Never submerge the motor base or the blade holder in water.
- Use a dry, soft cloth to clean the motor base. Do not clean this part with a wet cloth.

Maintenance

If the appliance does not operate normally, produces uncommon noises or shakes more than it normally does, stop using the appliance and contact the official Cecotec Technical Support Service for reparation. Do not carry out maintenance tasks yourself.

Storage

- After cleaning the appliance, make sure it is thoroughly dried before storing it.
- After using the appliance, store it in a dry, safe place.
- Avoid direct exposure to sunlight.
- Make sure it is stored in a place out of the reach of children.

5. TECHNICAL SPECIFICATIONS

Product reference: 03918/03933/03934/03935/03936

Product: RetroTwist Black/Yellow/Green/Red/Blue Jug blender

Voltage: 220-240 V

Frequency: 50-60 Hz

Rated power: 500 W

Maximum peak power of locked motor 800 W

Technical specifications may change without prior notification to improve product quality.

Made in China | Designed in Spain

6. DISPOSAL OF OLD ELECTRICAL AND ELECTRONIC APPLIANCES



This symbol indicates that, according to the applicable regulations, the product and/or batteries must be disposed of separately from household waste. When this product reaches the end of its shelf life, you should dispose of the cells/batteries/accumulators and take them to a collection point designated by the local authorities.

Consumers must contact their local authorities or retailer for information concerning the correct disposal of old appliances and/or their batteries.

Compliance with the above guidelines will help protecting the environment.

7. TECHNICAL SUPPORT AND WARRANTY

Cecotec shall be liable to the end user or consumer for any lack of conformity that exists at the time of delivery of the product under the terms, conditions, and deadlines established by the applicable regulations.

It is recommended that repairs be carried out by qualified personnel.

If at any moment you detect any problem with your product or have any doubt, do not hesitate to contact the official Cecotec Technical Support Service at +34 96 321 07 28.

8. COPYRIGHT

The intellectual property rights over the texts in this manual belong to CECOTEC INNOVACIONES, S.L. All rights reserved. The contents of this publication may not, in whole or in part, be reproduced, stored in a retrieval system, transmitted, or distributed by any means (electronic, mechanical, photocopying, recording or similar) without the prior authorization of CECOTEC INNOVACIONES, S.L.

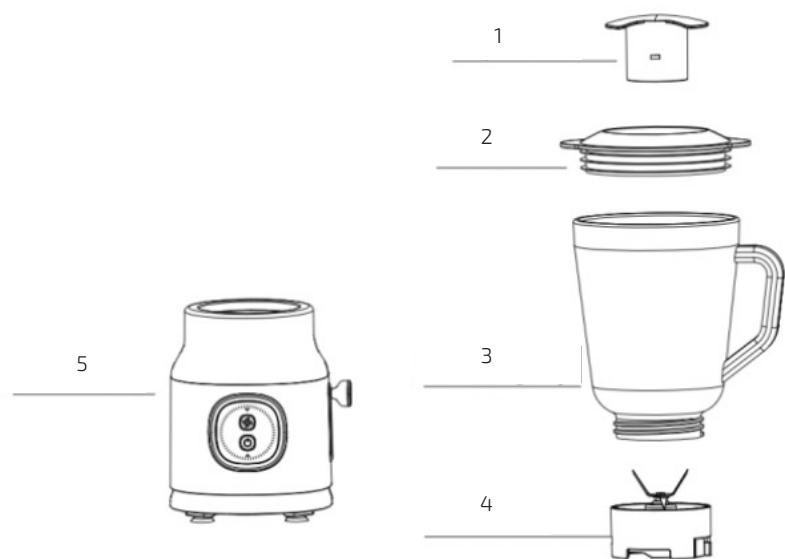

Fig./Img./Abb./Afb./ Rys. 1

www.cecotec.es

Cecotec Innovaciones S.L.
Av. Reyes Católicos, 60
46910, Alfafar (Valencia), Spain